

#5570

METALLIZED POLYPROYLLENE CAPACITORS

PPM 60-4.7 df K

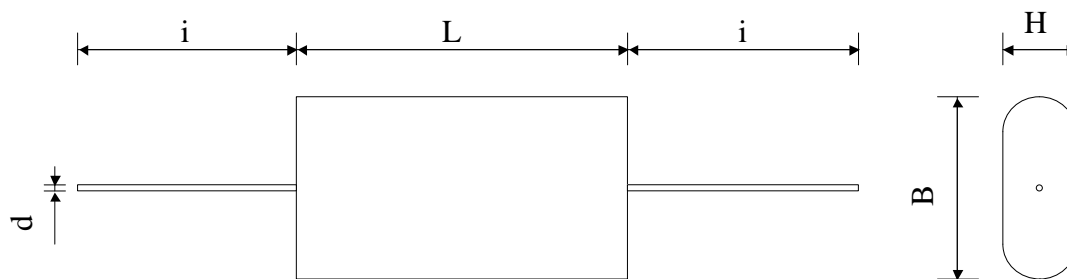

Dielectric of metallized polypropylene

Polyester wrapped / Epoxy resin sealing

Parameter	Symbol		Value	Unit	Condition
Capacitance	C		4.7	μF	1 V / 1 kHz
Tolerance			± 10	%	
Rated voltage	Un DC		600	VDC	
Rated voltage	Un AC		350	Veff	50 to 800 Hz
RMS current	I RMS max.		12	Aeff	10 kHz
slope of voltage variation	du/dt max.		55	V/ μsec	max. repetitive
Repetitive surge current	I cr. max		258	A	
Tangente delta	tg δ		≤ 4	10^{-4}	1 V / 1 kHz
Tangente delta	tg δ		≤ 20	10^{-4}	1 V / 10 kHz
Stray inductance	ESL		≤ 50	nH	
Insulation resistance	Ri		> 4200	M Ω	100 VDC - 1 min
Test voltage between terminals	U T1		1000	VDC	10 s
Climatic category			55/105/56		
Estimated operational life (-3%)			100'000	h	Un DC / 85°C
Dimension	Symbol			Unit	Conditions
Width	B max		42	mm	
Height	H max		26	mm	
Length	L max		45	mm	
Terminals					
Axial tinned wire	d		$\varnothing 1.0 \times 30$	mm	
	M1				
	M0				
	Modification	Date	Visa émetteur		

Condensateurs CH 1401 Yverdon-les-Bains
 Kondensatoren Tel.: ++41 24 445 66 88
 Capacitors Fax: ++41 24 445 66 89

Le Janché
Capacitors
A FISCHER & TALSCHER COMPANY

HJJ

12.06.2006

faisab5570.XLS