

#5559

METALLIZED POLYPROPYLENE CAPACITORS

PPM 100-8.0 cv2 K

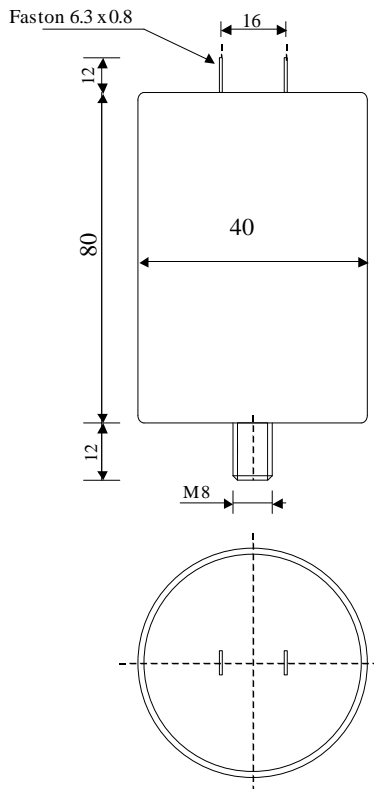

Dielectric of metallized polypropylene

FAST-ON 6.3 x 0.8 mm

Epoxy resin end sealing

Aluminium case

| Parameter | Symbol | Value | Unit | Condition |
|----------------------------------|-----------------------|------------|--------------------|-----------------|
| Capacitance | C | 8 | μF | 1 V / 1 kHz |
| Tolerance | | ± 10 | % | |
| Rated voltage | Un DC | 1000 | VDC | |
| Rated voltage | Un AC | 400 | VAC | 50 to 500 Hz |
| RMS Current | I _{eff max.} | 14 | A _{eff} | f > 10 kHz |
| slope of voltage variation | du/dt max. | 70 | V/ μsec | max. repetitive |
| Repetitive surge current | I cr. max | 560 | A | |
| Tangente delta | tg δ | ≤ 7 | 10^{-4} | 1 V / 1 kHz |
| Equivalent serie resistance | ESR | 12 | m Ω | 1 V / 10 kHz |
| Stray inductance | ESL | ≤ 130 | nH | |
| Insulation resistance | Ri | > 2500 | M Ω | 300 VDC - 1 min |
| Test voltage between terminals | U T1 | 1400 | VDC | 10 s |
| Climatic category | | 40/85/56 | | |
| Estimated operational life (-3%) | | 2000'000 | h | Un DC / 70°C |
| | | | | |
| | | | | |

| Dimension | Symbol | Value | Unit | Conditions |
|-------------|--------------|-----------|---------------|------------|
| Diameter | D | 40 | mm | |
| Height | H | 80 | mm | |
| Terminals | | | | |
| fast-on | | 6.3 x 0.8 | mm | |
| fixing stud | | M8 x 12 | mm | |
| | | | | |
| | | | | |
| | M1 | | | |
| | M0 | | | |
| | Modification | Date | Visa émetteur | |

Condensateurs CH 1401 Yverdon-les-Bains
 Kondensatoren Tel.: ++41 24 445 66 88
 Capacitors Fax: ++41 24 445 66 89

Le lanché
Capacitors
A FISCHER & TAUSSIG COMPANY

HJJ

20.04.2006

faisab5559.XLS