

#5421

METALLIZED POLYESTER CAPACITORS

MKTS 40-1.0 g K

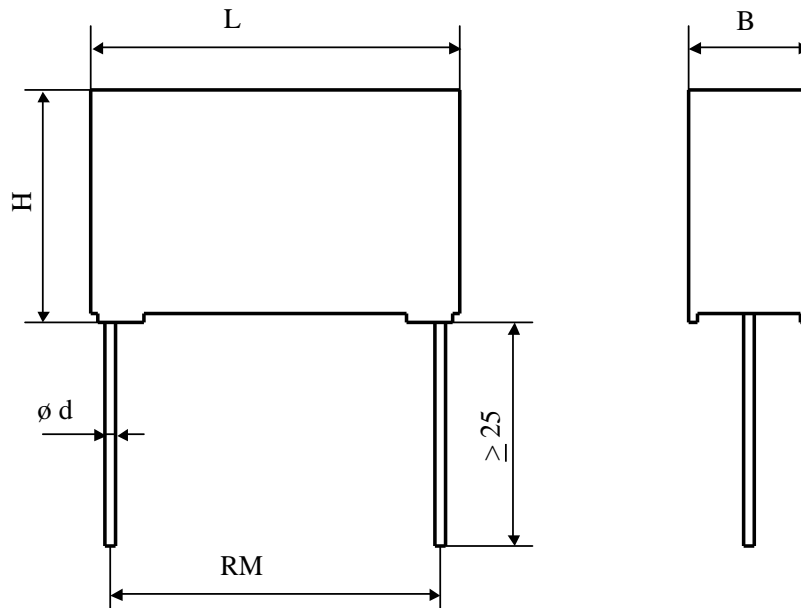

Dielectric of metallized polyester

Self-extinguishing plastic housing / Epoxy resin sealing

Parameter	Symbol		Value	Unit	Condition
Capacitance	C		1	µF	1 V / 1 kHz
Tolerance			± 10	%	
Rated voltage	Un DC		400	VDC	
RMS Current	I _{eff} max.		3	A _{eff}	40 kHz / 85°C
slope of voltage variation	du/dt max.		20	V/µsec	max. repetitive
Repetitive surge current	I cr. max		20	A	
Tangente delta	tgδ		100	10 ⁻⁴	1 V / 1 kHz
Stray inductance	ESL		≤ 40	nH	
Insulation resistance	Ri		> 10'000	MΩ	100 VDC - 1 min
Test voltage between terminals	U T1		640	VDC	10 s
Climatic category			55/125/21		
Dimension	Symbol			Unit	Conditions
Width max	B		8.5	mm	
Height max	H		18	mm	
Length max	L		26.5	mm	
Terminals					
Axial tinned wire	d		ø 0.8 x 25	mm	
	RM		22.5	mm	
capinfo@Lcap.ch www.Lcap.ch	M1				
	M0				
	Modification	Date	Visa émetteur		

Condensateurs CH 1400 Yverdon-les-Bains
 Kondensatoren Tel.: +41 24 445 66 88
 Capacitors Fax: +41 24 445 66 89

Leclanché
Capacitors
A FISCHER & TAUSSCH COMPANY

289

13.05.2004

faisab5421.XLS