

#5857

Power Electronics Capacitors

MKS 4-022 SMD K

PRELIMINARY

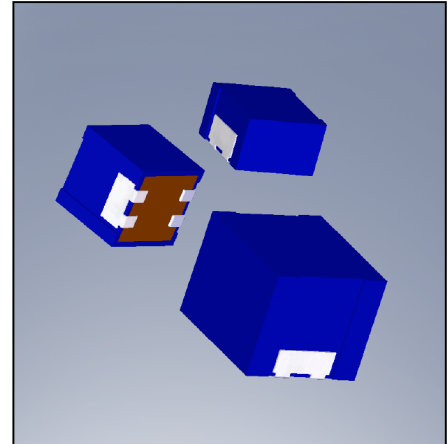
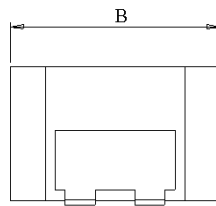
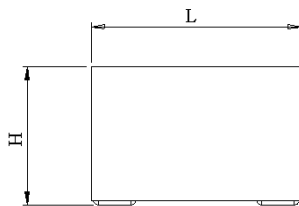
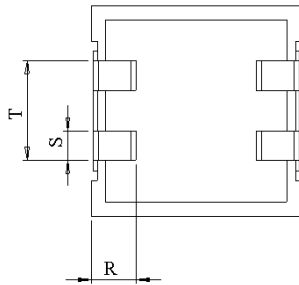

Surface mount device - Self-extinguishing plastic housing  
Dielectric metallized polyphenylene sulfide - Epoxy resin sealing UL 94-V0

Parameter	Symbol		Value	Unit	Condition
Capacitance	C		0.22	$\mu\text{F}$	1 V / 1 kHz
Tolerance			$\pm 10$	%	
Rated voltage	Un DC		40	VDC	
RMS current	I RMS max.			Aeff	
slope of voltage variation	du/dt max.			V/ $\mu\text{sec}$	
Repetitive surge current	I cr. max			A	
Tangent delta	tg $\delta$		$\leq 20$	$10^{-4}$	1 kHz / 23°C
Equivalent serie resistance	ESR			m $\Omega$	
Stray inductance	ESL			nH	
Insulation resistance	Ri		> 30'000	M $\Omega$	10 VDC - 1 min
Test voltage between terminals	U T1		64	VDC	10 s
Climatic category			55/125/56		
Dimension	Symbol			Unit	Conditions
Width	B max		7.5	mm	
Height	H max		4.5	mm	
Length	L max		8	mm	
Terminals					
	R		2.25 $\pm$ 0.25	mm	
	S		1.0 $\pm$ 0.2	mm	
	T		4.0 $\pm$ 0.2	mm	
	M1				
	M0				
	Modification	Date	Visa émetteur		

Condensateurs CH 1400 Yverdon-les-Bains  
Kondensatoren Tel.: ++41 24 445 66 88  
Capacitors Fax: ++41 24 445 66 89

**Le lanché**  
**Capacitors**  
A FISCHER & TAUSSCH COMPANY

HJJ

24.09.2009

faisab5857.XLS