

#5771

Power Capacitors

PAM 135-3x1.0 r K

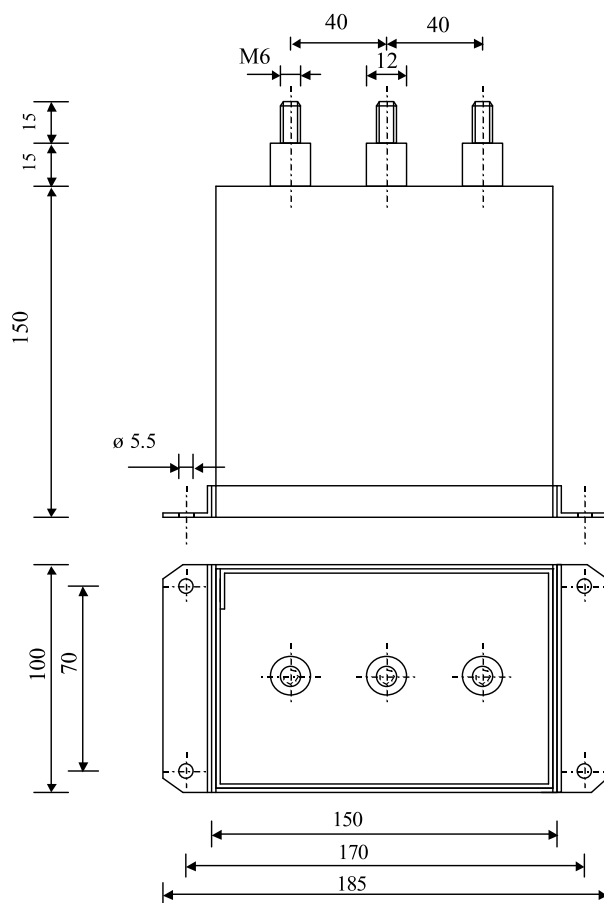

Preliminary
data sheet

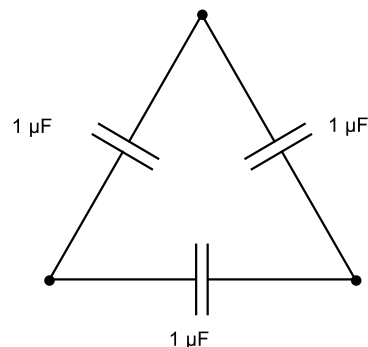

Dielectric :
metallized polypropylene
Threaded outputs
Resin end sealing
Aluminium case thick 1.2 mm

Parameter	Symbol		Value	Unit	Condition
Capacitance	C		3 x 1	µF	1 V / 100 Hz
Tolerance			± 10	%	
Nominal voltage	Un		1'350	VAC	
slope of voltage variation	du/dt max.		300	V/µsec	max. repetitive
Insulation resistance	Ri x C		> 20'000	s	500 VDC - 1 min
Test voltage between terminals	U T1		7'500	VDC	60 s
Test voltage between terminals to case	U T2		5'000	VAC	60 s
Climatic category (IEC 60068)			40/70/56		
Estimated operational life (-5%)			100'000	h	Un AC / 70°C
Dimension	Symbol			Unit	Condition
Width	B		100	mm	
Length	L		150	mm	
Height	H		150	mm	
Thread			3 x M6 x 15	mm	
Thread spacing			40	mm	
	M1				
	M0				
	Modification	Date	Visa émetteur		

Condensateurs
Kondensatoren
Capacitors

CH 1400 Yverdon-les-Bains
Tel.: ++41 24 445 66 88
Fax: ++41 24 445 66 89

Le lanché
Capacitors
A FISCHER & VANDECHÉ COMPANY

HJJ

02.12.2008

faisab5771.XLS