

#5898

Metallized polypropylene capacitors

PPM 380-2.0 r K

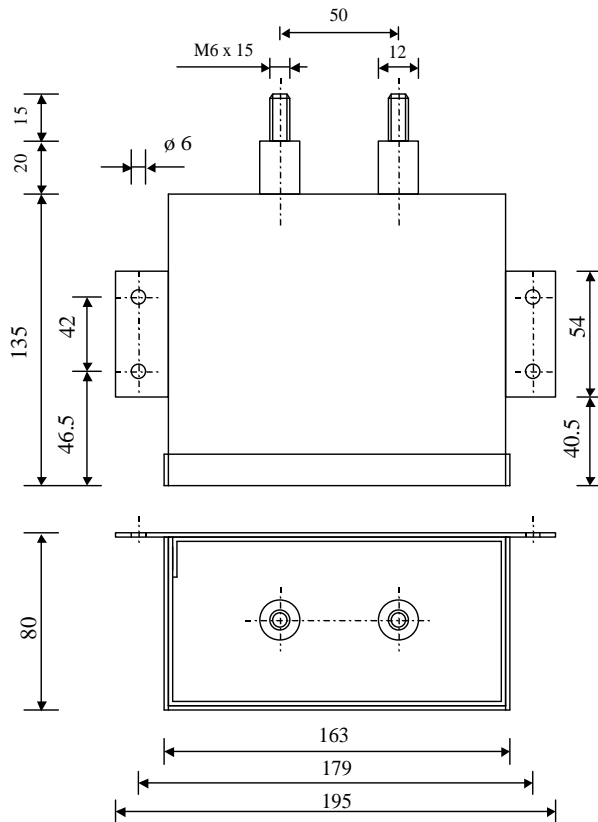

Dielectric of metallized polypropylene

Construction entirely dry components

Threaded outputs

Resin end sealing

Aluminium case thick 1.2 mm

Grounding direct in case

Parameter	Symbol	Value	Unit	Condition
Capacitance	C	2	$\mu\text{F}$	1 V / 1 kHz
Tolerance		$\pm 10$	%	
Rated voltage	Un DC	3'800	VDC	
Rated voltage	Un AC	1300	Veff	50 Hz
Maximum Voltage	U max	2800	Veff	50 Hz
RMS Current	Ieff	15	Aeff	10 kHz
slope of voltage variation	du/dt max.	200	V/ $\mu\text{sec}$	max. repetitive
Repetitive surge current	I cr. max	400	A	
Tangent delta	tg $\delta$	8	$10^{-4}$	1 V / 1 kHz
Stray inductance	ESL	$\leq 450$	nH	
Insulation resistance	Ri x C	$> 20'000$	s	500 VDC - 1 min
Test voltage between terminals	U T1	6'000	VDC	1 min
Test voltage between terminals to case	U T2	6'000	VDC	1 min
Operating temp.		- 25 / + 70 °C		
Dimension	Symbol	Value	Unit	Conditions
Width	B	80	mm	
Length	L	163	mm	
Height	H	135	mm	
Thread		M6 x 15	mm	
Thread spacing		50	mm	
	M1			
	M0			
	Modification	Date	Visa émetteur	

Condensateurs CH 1400 Yverdon-les-Bains  
 Kondensatoren Tel.: ++41 24 445 66 88  
 Capacitors Fax: ++41 24 445 66 89

**Le Lanché**  
**Capacitors**  
A FISCHER & TAUSSCHER COMPANY

HJJ

15.02.2010

faisab5898.XLS