

#6292

Discharge capacitors

PPMF 200-1.0 cs5 K

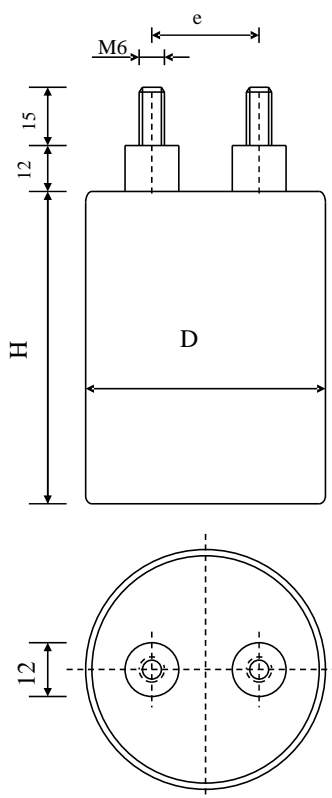

Dielectric of metallized polypropylene

Threaded outputs

Resin end sealing

Aluminium case

Parameter	Symbol	Value	Unit	Condition
Capacitance	C	1	μF	1 V / 1 kHz
Tolerance		± 5	%	
Rated voltage	$U_n \text{ DC}$	2000	VDC	
RMS Current permanent	$I_{\text{eff max.}}$	14	Aeff	10 kHz
Repetitive surge current	$I_{\text{cr. max}}$	1500	A	
Tangent delta	$\text{tg}\delta$	≤ 6	10^{-4}	1 V / 1 kHz
Equivalent serie resistance	ESR	< 6.5	$\text{m}\Omega$	1 V / 10 kHz
Stray inductance	ESL	≤ 90	nH	
Insulation resistance	$R_i \times C$	$\geq 20'000$	s	500 VDC - 1 min
Test voltage between terminals	U T1	3000	VDC	10 s
Test voltage terminals to case	U T2	3000	VAC	50 Hz / 1 min
Operating temp.		$-30 / +70$	$^{\circ}\text{C}$	
Estimated operational life		$> 7 \text{ M}$	Pulses	2000 V / 1500 A
Repetition rate	F	< 16	Hz	
Dimension	Symbol		Unit	Conditions
Diameter	D	60	mm	
Height	H max	50	mm	
Terminals				
Thread		M6 x 15	mm	
Thread spacing	e	24 ± 0.5	mm	
	M1			
	M0			
	Modification	Date	Visa émetteur	

Condensateurs CH 1400 Yverdon, Switzerland
 Kondensatoren Tel.: ++41 24 447 22 82
 Capacitors Fax: ++41 24 447 22 85

Leclanché
Capacitors
A FRICKER & MAUSCHER COMPANY

HJJ

www.Lcap.ch
 16.04.2014

capinfo@Lcap.ch
 faisab6292.XLS