

#	Discharge Capacitor	TYPE PPMF 200-10.0
---	---------------------	-----------------------

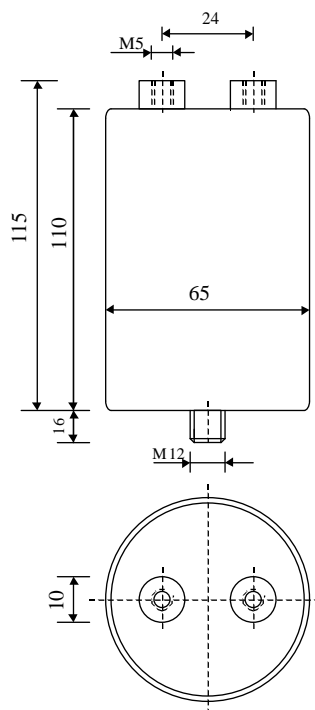

Aluminium housing  $\varnothing$  65 x 110

2 inserts M5 x 10

Resin-epoxy

Parameter	Symbol	Value	Units	Conditions
Capacitance	C	10	$\mu$ F	20°C, 1 kHz
Tolerance		$\pm$ 10	%	
Operating voltage	Un DC	2000	VDC	
Operating voltage	Un AC	800	VAC	50 Hz
Peak	Us	2500	V	
Max RMS current	I eff	30	A	f > 600 Hz
Repetitive peak current	I cr.	1300	A	
Tangent delta	tg $\delta$	$\leq$ 5 E-4		1 V - 50 Hz
Serial resistance	ESR	$\leq$ 5.0	m $\Omega$	1 V - 10 kHz
Time constant	Ri x C	$\geq$ 10'000	s	500 V - 1 min
Serial inductance	ESL	$\leq$ 190	nH	
Climatic category		25/70/56		
Test voltage between terminals	Ut 1	3000	VDC	10 s
Test voltage between terminal and housing	Ut 2	3000	VAC	50 Hz - 1 min
Estimated Lifetime		100 x 10 <sup>6</sup>	discharges	2000 V / 1300 A

Dimensions	Symbol	Value	Units	Conditions
Diameter	D	65	mm	
Total	H	110	mm	
Connexions				
Inserts		M5 x 10	mm	
Pitch		24	mm	

	M2			
	M1			
	M0			
	Modification	Date	Author	