

Capacitor for power electronics

TYPE
PAM 100-010 cv4

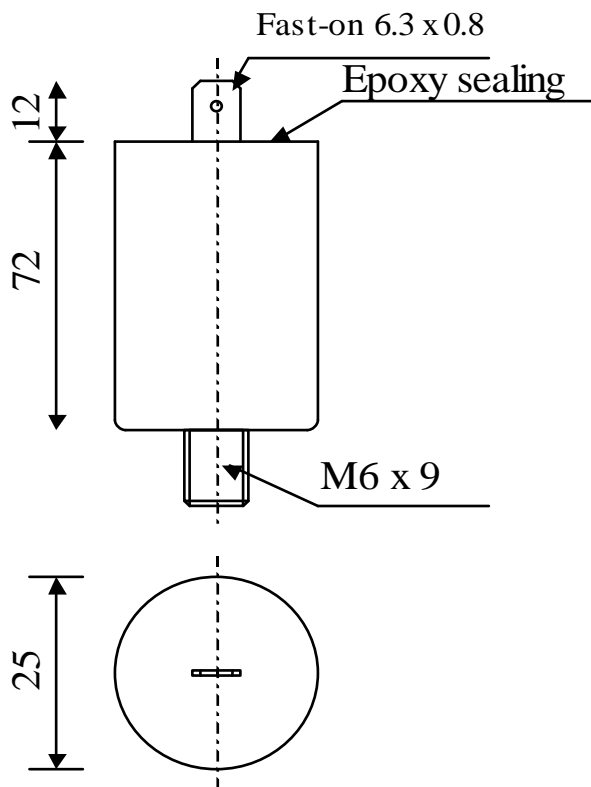

Dielectric of metallized polypropylene

FAST-ON 6.3 x 0.8 mm

Epoxy resin end sealing

Aluminium case

Paramètre	Symbol	Value	Unit	Condition
Capacitance	C	100	nF	20°C, 1 kHz
Tolerance		± 10	%	
Rated voltage	Un AC	1000	VAC	50 Hz
Rated voltage	Un DC	1400	VDC	
RMS current max	I eff	10	A eff	
slope of voltage variation	du/dt max.	2200	V/μs	
Equivalent Series Resistance	Rs	<20	mOhm	
Stray inductance	ESL	≤ 20	nH	
Test voltage	U T	2130	VAC	50Hz, 2 s.
Climatic category		25/85/56		

Dimension	Symbole	Value	Unité	Conditions
Diameter	ø D	25	mm	
Height	H	72	mm	
Terminals				
fast-on		6.3 x 0.8	mm	
fixing stud		M6 x 9	mm	

Valeurs indicatives, sous réserve de modification	M2			
	M1			
	M0			
	Modification	Date	Visa émetteur	

Condensateurs CH 1401 Yverdon, Switzerland
 Kondensatoren Tel.: ++41 24 445 66 88
 Capacitors Fax: ++41 24 445 66 89



12.08.2009

capinfo@lcap.ch