

Ordering code: OBIC 120-022 cv2S (K)
Applications: MKP-1 AC/DC capacitor for general use in power electronics also for nonsinusoidal voltages and currents
Standard: acc. to IEC 61071:2007

Characteristics

Rated capacitance	C_N	0.22 µF ±10%
Rated a.c. voltage	U_{NAC}	1200 V a.c.
Max. rms voltage (sinusoidal)	U_{rms}	850 V
Non-recurrent surge voltage	u_s	2100 V
Rated energy	E_N	0.2 Ws
Maximum current	I_{max}	10 A
Maximum peak current	I_̂	0.2 kA
Maximum surge current	I_s	0.6 kA
Series resistance	R_s	7.5 mΩ
Dielectric dissipation factor	tanδ_o	2 x 10 ⁻⁴
Self discharge time constant	C x R_{is}	>25000 s
Self inductance	L_e	60 nH

Thermal characteristics

Lowest operating temperature	Θ_{min}	-25 °C
Maximum operating temperature	Θ_{max}	85 °C
Storage temperature	Θ_{storage}	-40..+85 °C
Thermal resistance	R_{th}	25.6 K/W

Routine test voltages

Voltage test between terminals	U_{TT}	2580 V DC/10s
Voltage test terminals to case	U_{TC}	3000 V AC/10s

Statistical lifetime

>200000 h

Failure rate

<100 FIT*

at Θ_{hotspot}

≤70 °C

* See FIT-RATE diagram on p.4

Dimensions

Rated diameter	D₁	30 (+1) mm
Length of the case	L₁	58 (±2) mm
Length of the terminals	L₂	16 (+3) mm
Distance btw. terminals	a	17 (±1) mm
Terminal		tab connector 6.3x0.8
Base mounting stud	G_BxL_B	M8x10 (+1) mm
Clearance in air	L	7.5 mm
Creepage distance	K	9 mm
Approx. weight		0.05 kg

Mechanical characteristics

Dielectric	metallized polypropylene capacitor, selfhealing
Construction	aluminium can, plastic with rubber sealing, flanged can
Protection	BAM™ overpressure break action mechanism
Terminals	single tab connectors 6.3 x 0.8 mm / plastic lid
Impregnant	liquid impregnant, no PCB
Fire load	2MJ

Outline drawing

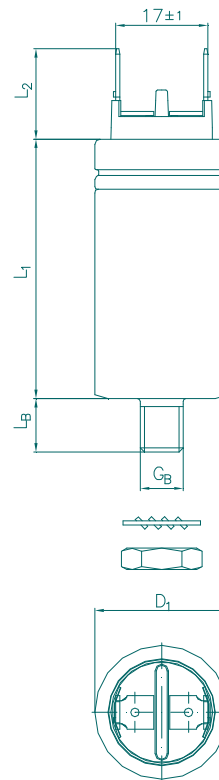

Permitted power losses during continuous operation

