

RoHS compliant
 REACH compliant

Features

- With cap and connecting cable or plug in tags
- With clamp attachment or mounting stud
- Cable outcoming radial or axial
- VDE approval for selected products

Applications

- Motorstart
- Whitegood motorcontrol

Different case sizes, voltages and capacitance combinations are available on request. Also in small lots.

General specifications

Items	Characteristics
Clima category	10/060/21
Tolerance	±10%
Specs. for selected items	VDE DIN EN 60252-2
Terminals	Cap and cable or faston tags 4,8 mm, 6,3 mm single and double

The alternated current load may occur at most 20 times per hour with the following values:	
Percentage duty cycle	
AB 0,55 % ED	20 turn-ons with each 1,0 sec duration
AB 1,50 % ED	20 turn-ons with each 2,7 sec duration
AB 1,70 % ED	20 turn-ons with each 3,0 sec duration

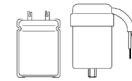

Drawings for series MEK

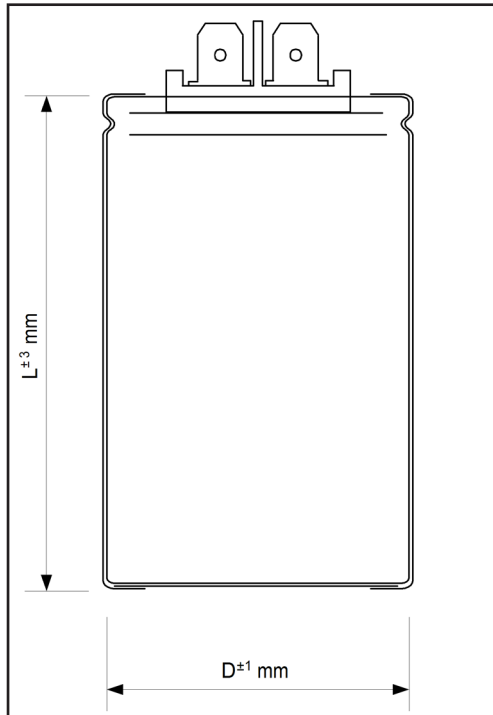

Standard values type MEK

$U_R \sim$ 50-60 Hz	C_R	DC* @50 Hz	DC* @60 Hz	D x L / with cap	VDE sign	Order code
[V]	[μ F]	[%]	[%]	[mm]		MEK...
320 V ~	10	1,70	1,36	35x51 / 70	yes	10032035051
	15	1,70	1,36	35x 66 / 85	yes	15032035066
	20	1,70	1,36	35x 66 / 85	yes	20032035066
	25	1,70	1,36	35x 66 / 85	yes	25032035066
	30	1,70	1,36	35x 66 / 85	yes	30032035066
	40	1,70	1,36	35x 66 / 85	yes	40032035066
	50	1,70	1,36	35x 66 / 85	yes	50032035066
	60	1,70	1,36	35x 66 / 85	yes	60032035066
	70	1,70	1,36	35x 66 / 85	yes	70032035066
	80	1,70	1,36	40x 66 / 85	yes	80032040066
	90	1,70	1,36	40x 66 / 85	yes	90032040066
	100	1,70	1,36	40x 66 / 85	yes	10132040066
	125	1,70	1,36	50x 66 / 112	yes	12132050066
	140	1,70	1,36	50x 96 / 112	-	14132050096
	160	1,70	1,36	50x 96 / 112	-	16132050096
	180	1,70	1,36	50x 96 / 112	-	18132050096
200	1,70	1,36	50x 96 / 112	-	20132050096	

Special versions of the MEK

$U_R \sim$ 50-60 Hz	C_R	DC @50 Hz	D x L	VDE sign	Order code
[V]	[μ F]	[%]	[mm]		MEK...
320 V ~	95	0,60	35 x 66	-	95032035066
250 V ~	220	0,55	35 x 76	-	22125035076

Please state additionally to your order:

- with or without cap
- cable length
- with or without discharge resistor 22 kW, 47 kW (Standard), 100 k Ω