

Leclanché Capacitors
48, av. de Grandson
1400 Yverdon, Switzerland



Tel. +41 24 445 66 88
Fax +41 24 445 66 89
capinfo@Lcap.ch
www.Lcap.ch

Drawing No. : 1024806-53567

created from : 14/03/2013 16:56:00

Part Number : GWE90140050065

	<p>∅ D : 50 mm</p> <p>L : 65,7±1 mm</p> <p>LüA 69,2±1 mm</p> <p>a : 22±0,5 mm</p> <p>S3 : 52 mm</p> <p>Terminals : 1900-32-UNJF-3B</p>	
--	---	--

Electrical Parameter

Rated Capacitance (C _R) @ 100 Hz / 20 °C	900 μF	
Tolerance	±10 %	
Rated Voltage (U _R)	400 V	
Surge Voltage (U _S) max. 5 x 1 min / h	440 V	
Reverse Voltage (U _U) max. 1 s	2 V	
Leakage Current (I _L) @ U _R / 5 min / 20 °C	2160 μA	
ESR typ. @ 100 Hz / 20°C	106 mΩ	
Tan δ typ. @ 100 Hz / 20°C	6 %	
Z max. @ 10 kHz / 20°C	85 mΩ	
ESL typ.	20 nH	
Useful life / No. flash @ I _R , U _R , 70°C	4000 h	10,8 Mio
IEC Climatic category / Standards	55/70/56	IEC 60384-4
Applications	Aviation Flash	

Leclanché Capacitors for Critical Applications and Extreme Environments

1400 Yverdon, Switzerland Tel +41 24 445 66 88 Fax +41 24 445 66 89 E-mail capinfo@Lcap.ch www.Lcap.ch

Leclanché Capacitors
48, av. de Grandson
1400 Yverdon, Switzerland

Leclanché
Capacitors
A FISCHER & TAUSCHE COMPANY

Tel. +41 24 445 66 88
Fax +41 24 445 66 89
capinfo@Lcap.ch
www.Lcap.ch

Drawing No. : 1024806-53567

created from : 14/03/2013 16:56:00

Part Number : GWE90140050065

Your article No. / Project

Possible major failure modes:

Breakdown - Probability 10 ppm beside early failure (unpredictable)

Corrosion (no contact) due to unknown impurities – Probability 1 ppm

End of life failure – dryout (lack of electrolyte), no capacitance

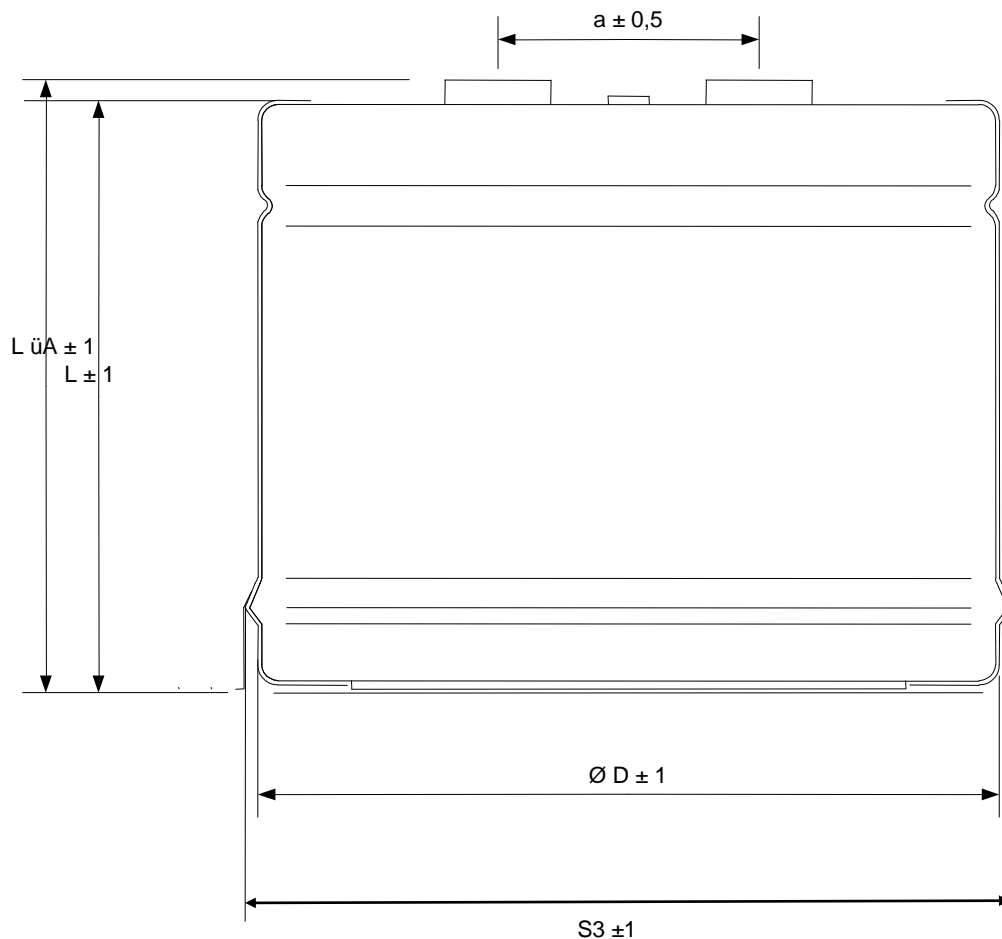

Leclanché Capacitors
48, av. de Grandson
1400 Yverdon, Switzerland



Tel. +41 24 445 66 88
Fax +41 24 445 66 89
capinfo@Lcap.ch
www.Lcap.ch

Drawing No. : 1024806-53567
created from : 14/03/2013 16:56:00

Part Number : GWE90140050065

3D Drawing -Disk

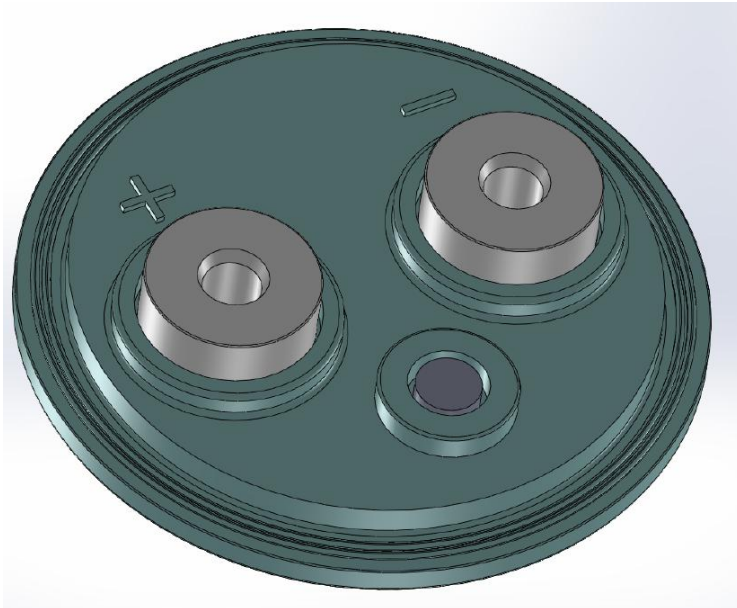

1. Terminals diameter and tolerance on the diameter $12,8 \pm 0,05$ mm

