

Leclanché Capacitors  
48, av. de Grandson  
1400 Yverdon, Switzerland



Tel. +41 24 445 66 88  
Fax +41 24 445 66 89  
[capinfo@Lcap.ch](mailto:capinfo@Lcap.ch)  
[www.Lcap.ch](http://www.Lcap.ch)

Drawing No. : 100010509  
created from : 21/09/2012 13:20:00

**Part Number : GMXA22235073115**

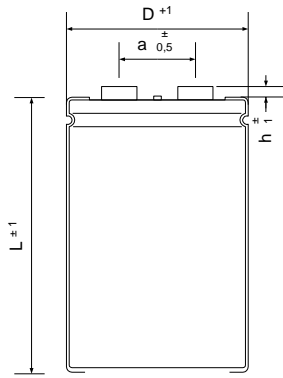

∅ D : 73 mm  
L : 115 mm  
a : 31,7 mm  
h : 4 mm  
:  
Terminals : M5

**Electrical Parameter**

|  |                      |                    |
|--|----------------------|--------------------|
| Rated Capacitance ( $C_R$ )<br>@ 100 Hz / 20 °C      | <b>2200</b> $\mu$ F  |                    |
| Tolerance  | <b>-10; +30</b> %    |                    |
| Rated Voltage ( $U_R$ )                              | <b>350</b> V         |                    |
| Surge Voltage ( $U_S$ )<br>max. 5 x 1 min / h        | <b>385</b> V         |                    |
| Reverse Voltage ( $U_U$ )<br>max. 1 s                | <b>2</b> V           |                    |
| Leakage Current ( $I_L$ )<br>@ $U_R$ / 5 min / 20 °C | <b>4620</b> $\mu$ A  |                    |
| ESR typ.<br>@ 100 Hz / 20°C                          | <b>43</b> m $\Omega$ |                    |
| Tan $\delta$ typ.<br>@ 100 Hz / 20°C                 | <b>6</b> %           |                    |
| Z max.<br>@ 10 kHz / 20°C                            | <b>34</b> m $\Omega$ |                    |
| ESL typ.   | <b>20</b> nH         |                    |
| Rated Ripple Current ( $I_R$ )<br>@ 100 Hz / 85 °C   | <b>6,4</b> A         |                    |
| Useful life<br>@ $I_R$ , $U_R$ , 85 °C               | <b>12000</b> h       |                    |
| IEC Climatic category / Standards                    | <b>40/085/56</b>     | <b>IEC 60384-4</b> |
| Applications   | General Industrial   |                    |
| Your article No. / Project                           |                      |                    |