

Leclanché Capacitors  
48, av. de Grandson  
1400 Yverdon, Switzerland



Tel. +41 24 445 66 88  
Fax +41 24 445 66 89  
[capinfo@Lcap.ch](mailto:capinfo@Lcap.ch)  
[www.Lcap.ch](http://www.Lcap.ch)

Drawing No. : 1029200-53567  
created from : TE 03/09/2015 15:36:00

**Part Number : GB60240075145**

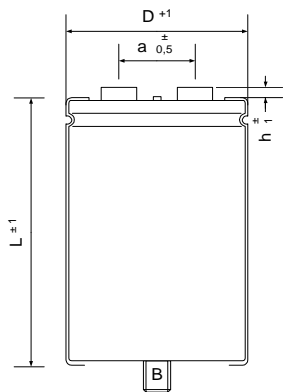

∅ D : 75 mm  
L : 145 mm  
a : 31,7 mm  
h : 4 mm  
B : M12  
Terminals : M5 (-) / M6 (+)

With isolation disk with no insert at the bottom

**Electrical Parameter**

Rated Capacitance ( $C_R$ ) @ 100 Hz / 20 °C	<b>6000</b> $\mu$ F	
Tolerance	<b>±10</b> %	
Rated Voltage ( $U_R$ )	<b>400</b> V	
Surge Voltage ( $U_S$ ) max. 5 x 1 min / h	<b>440</b> V	
Reverse Voltage ( $U_U$ ) max. 1 s	<b>2</b> V	
Leakage Current ( $I_L$ ) @ $U_R$ / 5 min / 20 °C	<b>7200</b> $\mu$ A	36000 $\mu$ A @ 70°C
ESR typ. @ 100 Hz / 20°C	<b>16</b> m $\Omega$	11 m $\Omega$ @ >8 kHz 240 m $\Omega$ @ -25°C 1280 m $\Omega$ @ -40°C
Tan $\delta$ typ. @ 100 Hz / 20°C	<b>6</b> %	
Z max. @ 10 kHz / 20°C	<b>13</b> m $\Omega$	
ESL typ.	<b>20</b> nH	
Rated Ripple Current ( $I_R$ ) @ 100 Hz / 105 °C	<b>20</b> A	
Useful life @ $I_R$ , $U_R$ , 105 °C	<b>8000</b> h	680 VDC 40Aeff 5%Vpp 150000 h @ 50°C 70000 h @ 70°C 1000 h@75°C
IEC Climatic category / Standards	<b>40/105/56</b>	<b>IEC 60384-4</b>
Applications	Traction	

Leclanché Capacitors  
48, av. de Grandson  
1400 Yverdon, Switzerland



Tel. +41 24 445 66 88  
Fax +41 24 445 66 89  
[capinfo@Lcap.ch](mailto:capinfo@Lcap.ch)  
[www.Lcap.ch](http://www.Lcap.ch)

Drawing No. : 1029200-53567  
created from : TE 03/09/2015 15:36:00

**Part Number : GB60240075145**

Your article No. / Project

ADES105927000/  
ADES105928000